

SITE PLAN OF A LAND WITH EXT. - II STD. OF SRI SHRIDHAR PATHAK & OTHERS IN RESPECT OF HOLDING NO. - 1131, LAKE TOWN, WARD NO. - 30, MOUZA - PATIPUKUR, J. L. NO. - 24, C.S. DAG NO - 425 & 412, PLOT NO. - 727 & 728, L.R. DAG NO. - 973, 643, R.S. DAG NO - 412, P. S. - LAKE TOWN, DIST. - 24 PARGANAS(N), UNDER SOUTH DUM DUM MUNICIPALITY.

NATURE OF LAND - NOT AVAILABLE

AREA STATEMENT

- TOTAL AREA OF LAND (AS PER DEED) - 05K - 00 CH - 00 SFT. = 334.45 Sqm
- TOTAL AREA OF LAND (AS PER PHYSICAL) ----- 334.04 Sqm
- PERMISSIBLE COV. AREA (58.30%) ----- 194.74 Sqm.

SITE PLAN FOR PROPOSED BLDG. PLAN AS PER RULES.

I DO HEREBY DECLARE THAT THERE IS NO COURT CASE OR ANY COMPLAIN FROM ANY CORNER OF MY PROPERTY AS PER PLAN. I ALSO DECLARE THAT I HAVE NOT SOLD ANY PORTION OF PROPERTY SHOWN IN PLAN TO ANYBODY UPTILL NOW. IF ANY PROBLEM ARISES IN FUTURE THEN THE SOUTH DUMDUM MUNICIPALITY WILL NOT BE LIABLE FOR THAT.

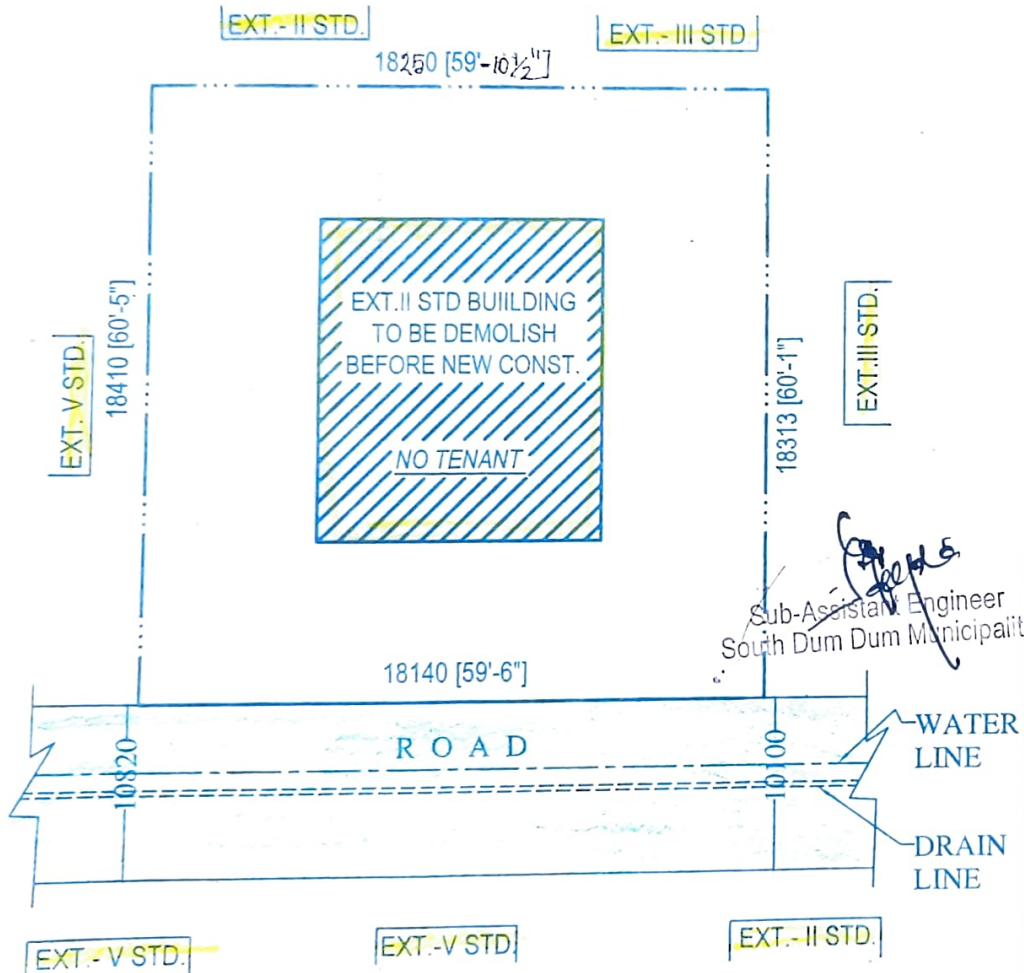

SITE PLAN

(SCALE -1:200)

SCALE -1:200



RAMSISARIA REALTORS PRIVATE LIMITED

Ashwin Tewari

Director

SIGNATURE OF OWNER

Ashut Kumar Pal
ASHUT KUMAR PAL
 Licensed Building Surveyor
 Class - II Lic No - SDOM/ L.B. S/24

SIGNATURE OF L. B. S.